

NOTES
1. WHEN USED ON HIGH SIDE OF ROADWAYS, MATCH THE CROSS SLOPE OF THE GUTTER TO THE CROSS SLOPE OF THE ADJACENT PAVEMENT. THE THICKNESS OF THE LIP IS 3/4", UNLESS OTHERWISE SHOWN ON PLANS.

1 STANDARD CURB AND GUTTER
C-260 SCALE: N.T.S.

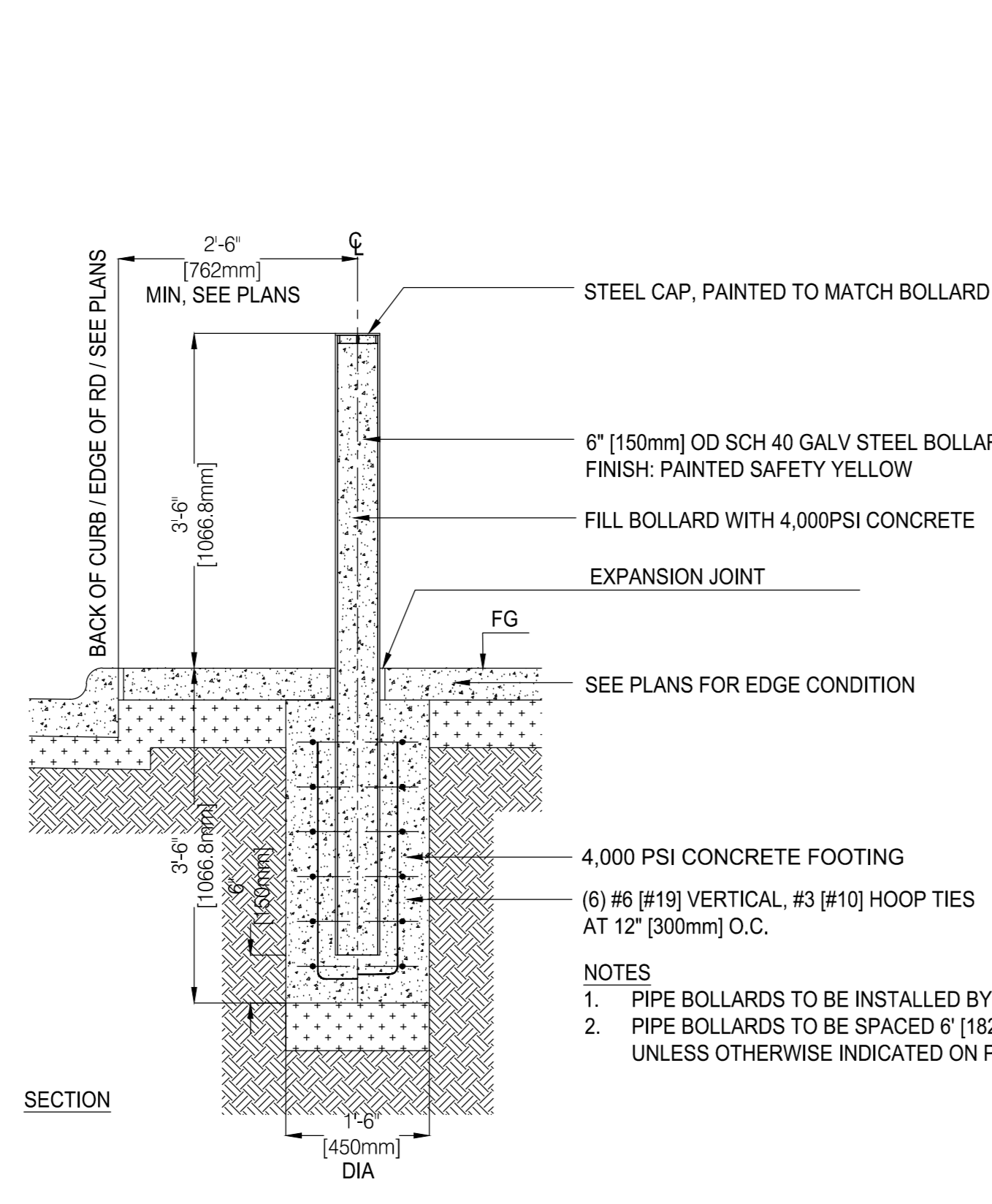

2 FIXED PIPE BOLLARD
C-260 SCALE: N.T.S.

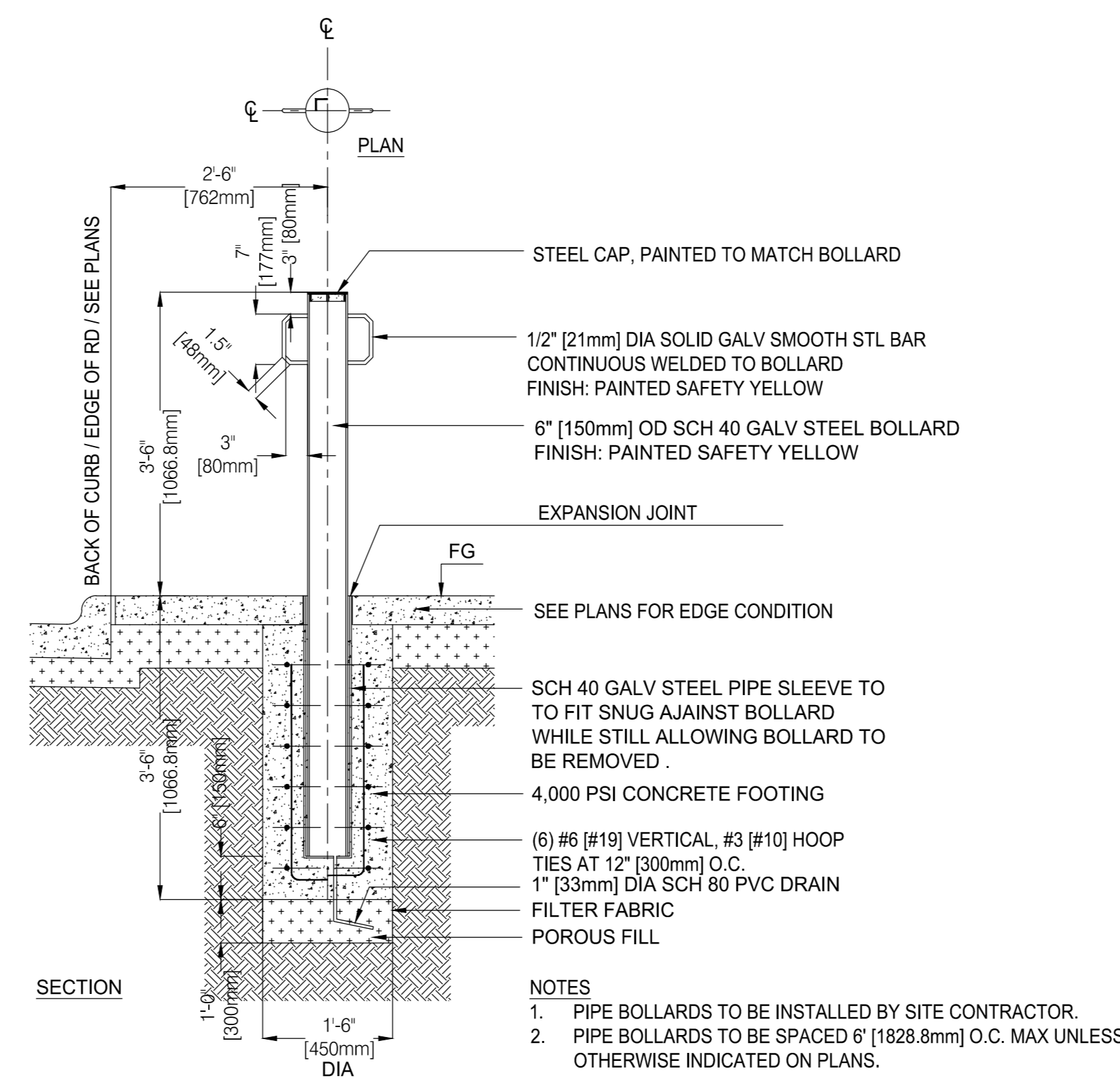

3 REMOVABLE PIPE BOLLARD
C-260 SCALE: N.T.S.

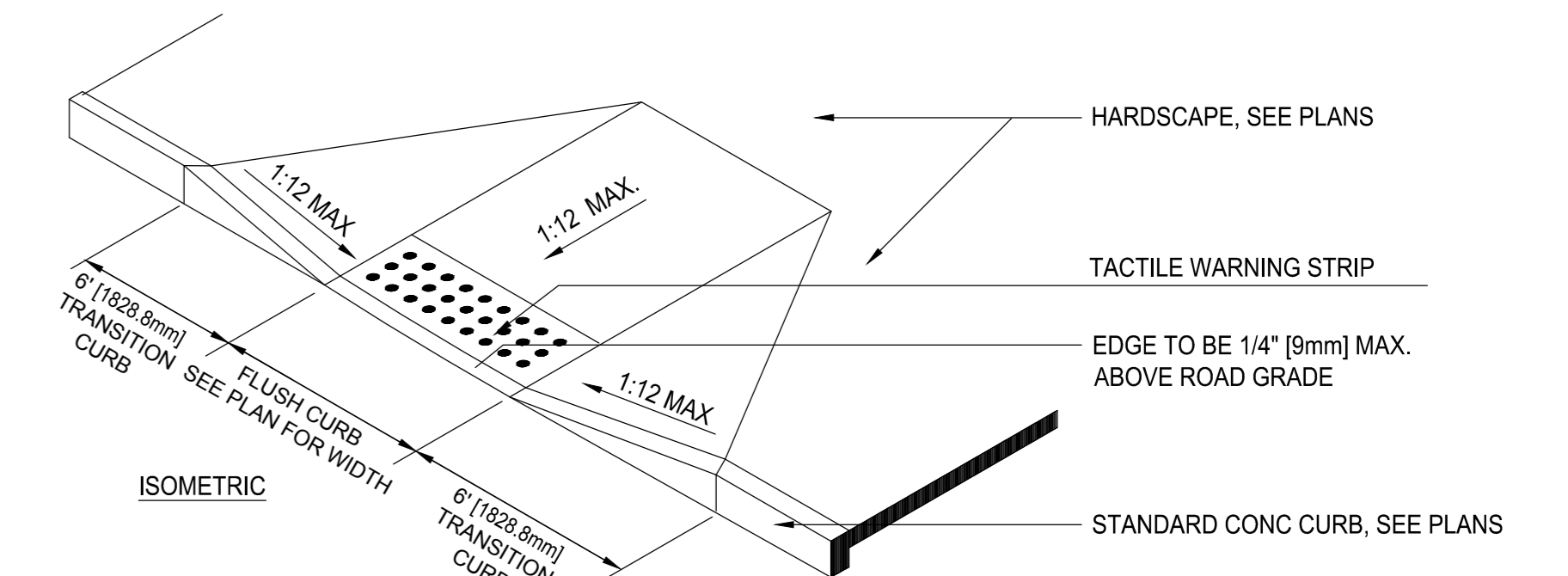
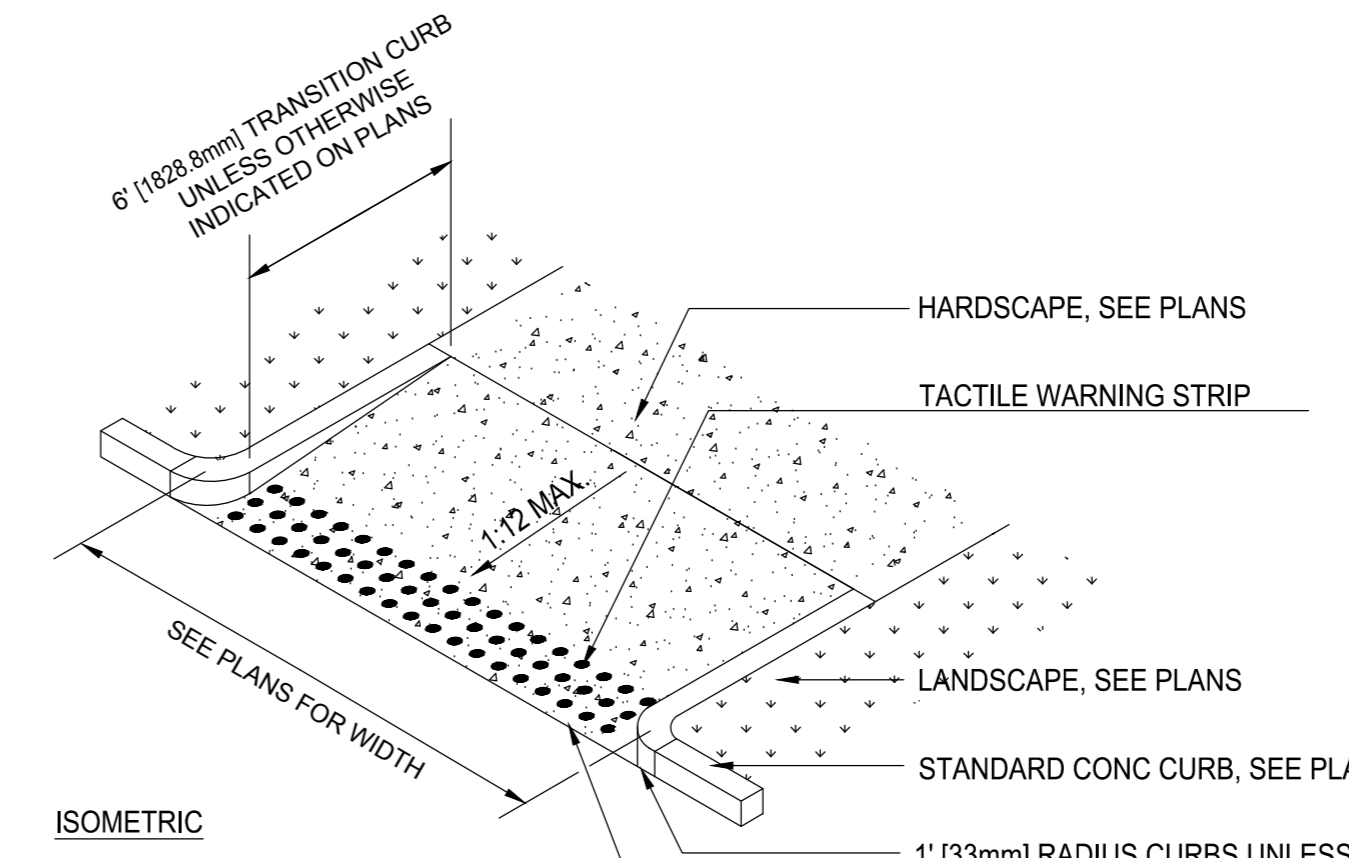

4 SIDEWALK RAMP
C-260 SCALE: N.T.S.

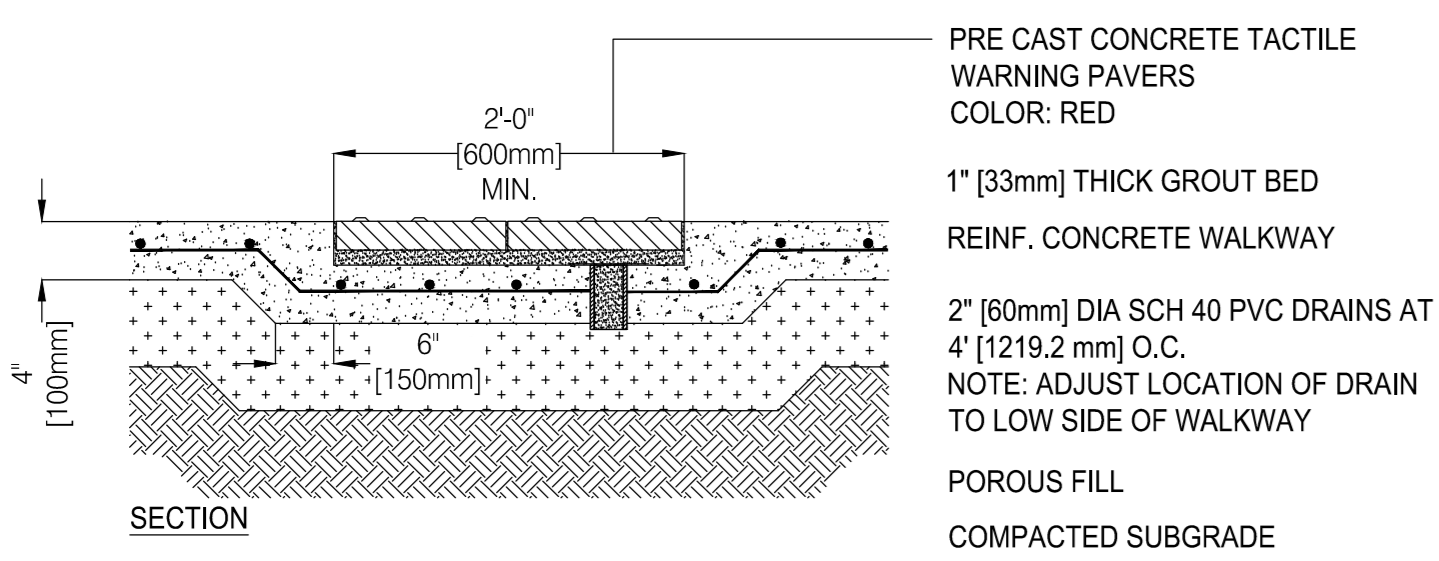

5 TACTILE WARNING STRIP
C-260 SCALE: N.T.S.

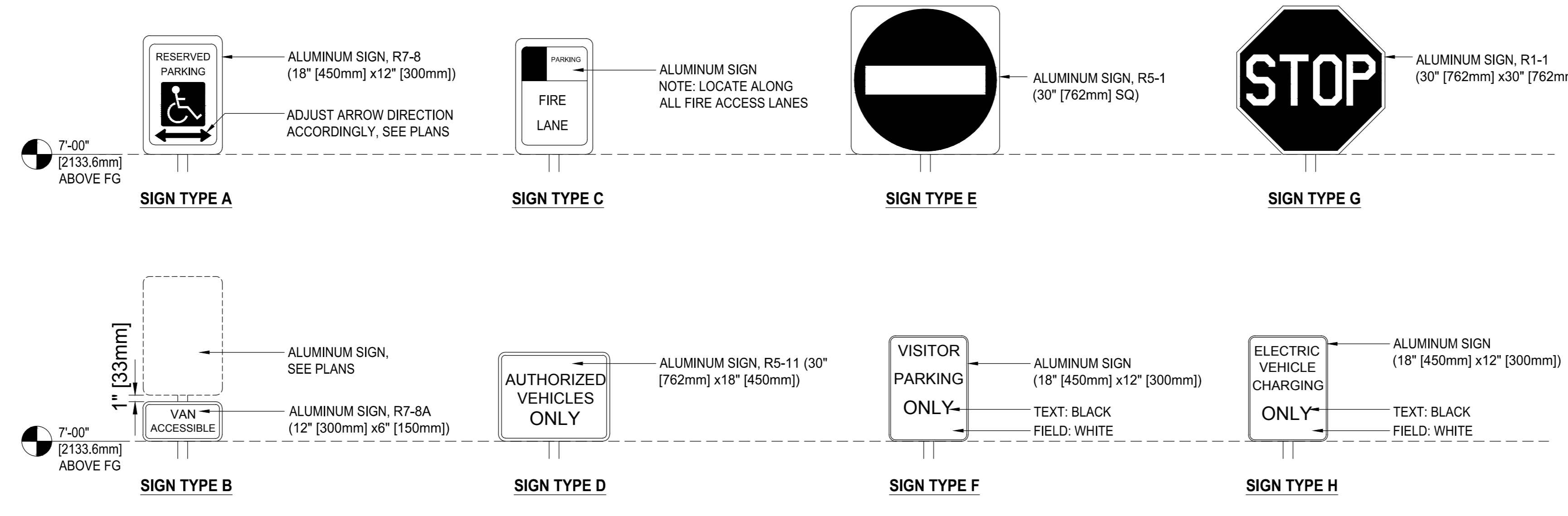

6 SITE SIGNAGE REGULATORY AND WARNING SIGNS
C-260 SCALE: N.T.S.

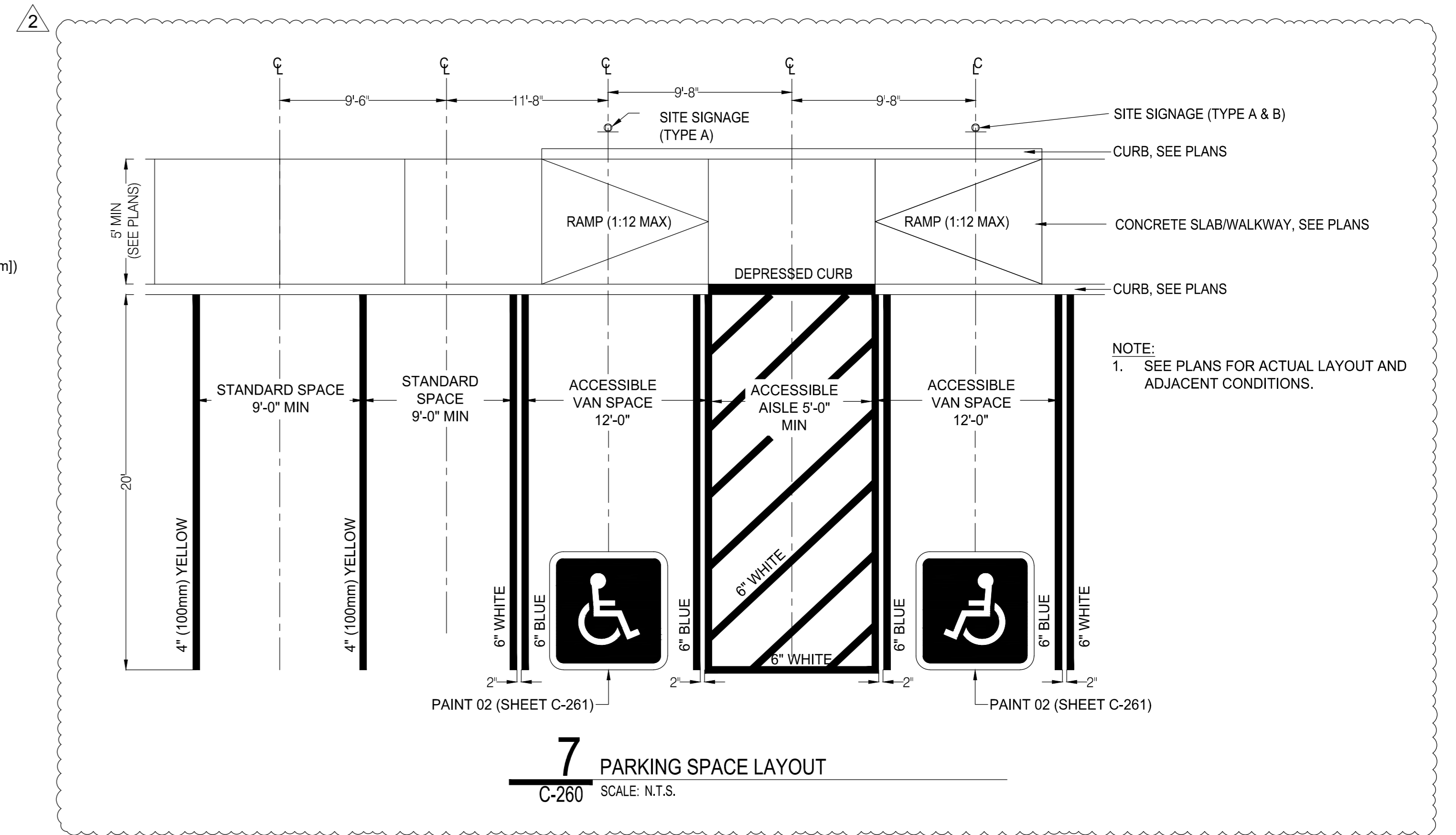

7 PARKING SPACE LAYOUT
C-260 SCALE: N.T.S.

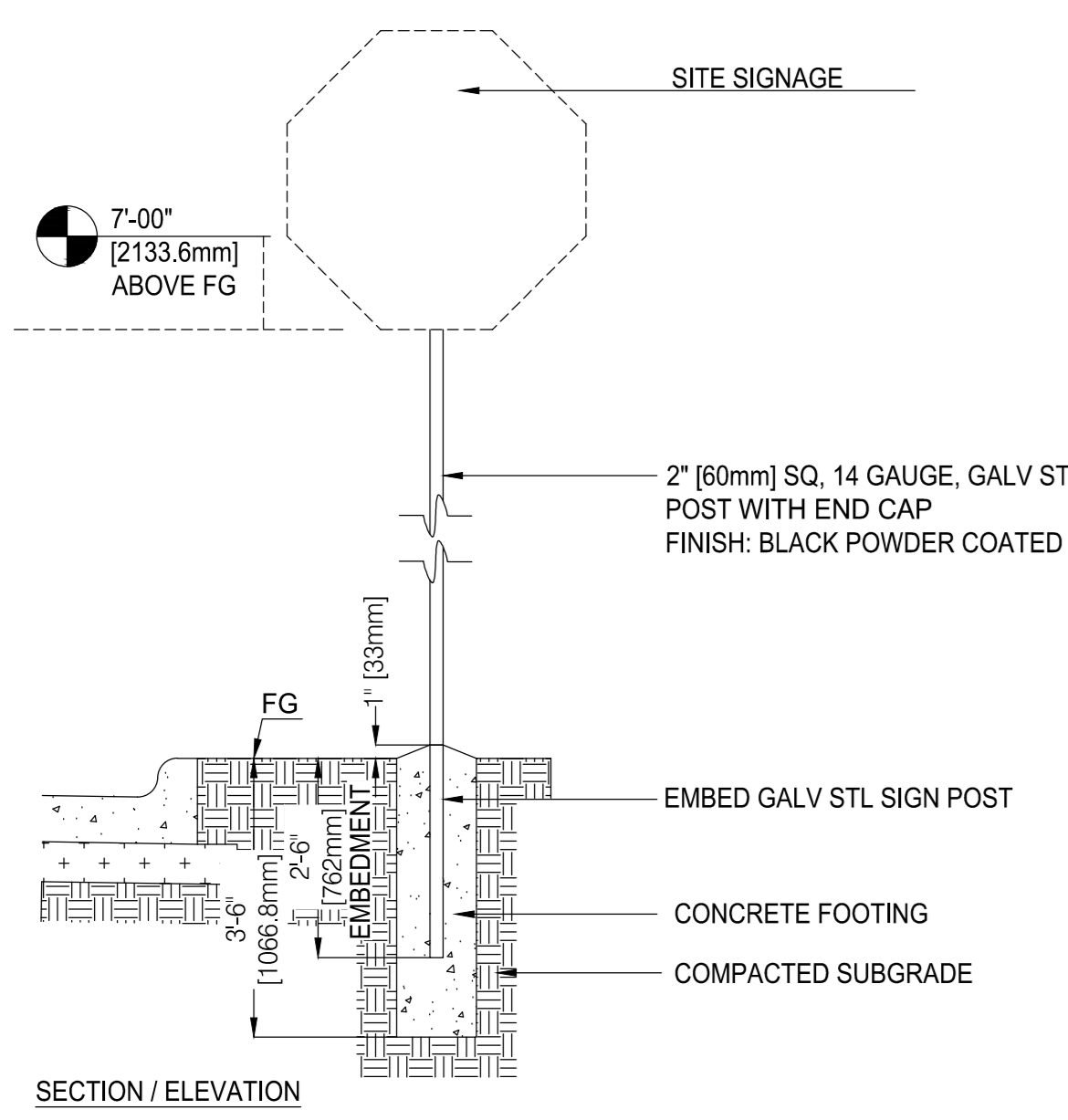

8 SINGLE SITE SIGNAGE POST
C-260 SCALE: N.T.S.

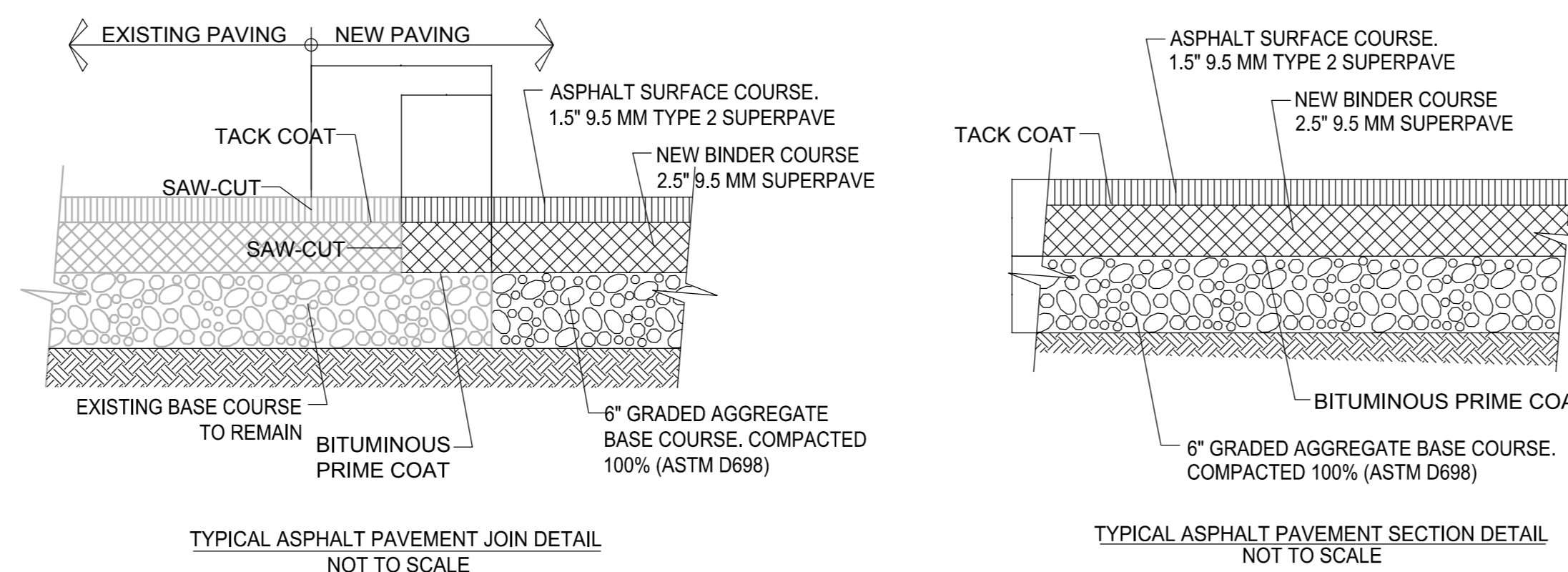

9 ASPHALT PAVEMENT
C-260 SCALE: N.T.S.

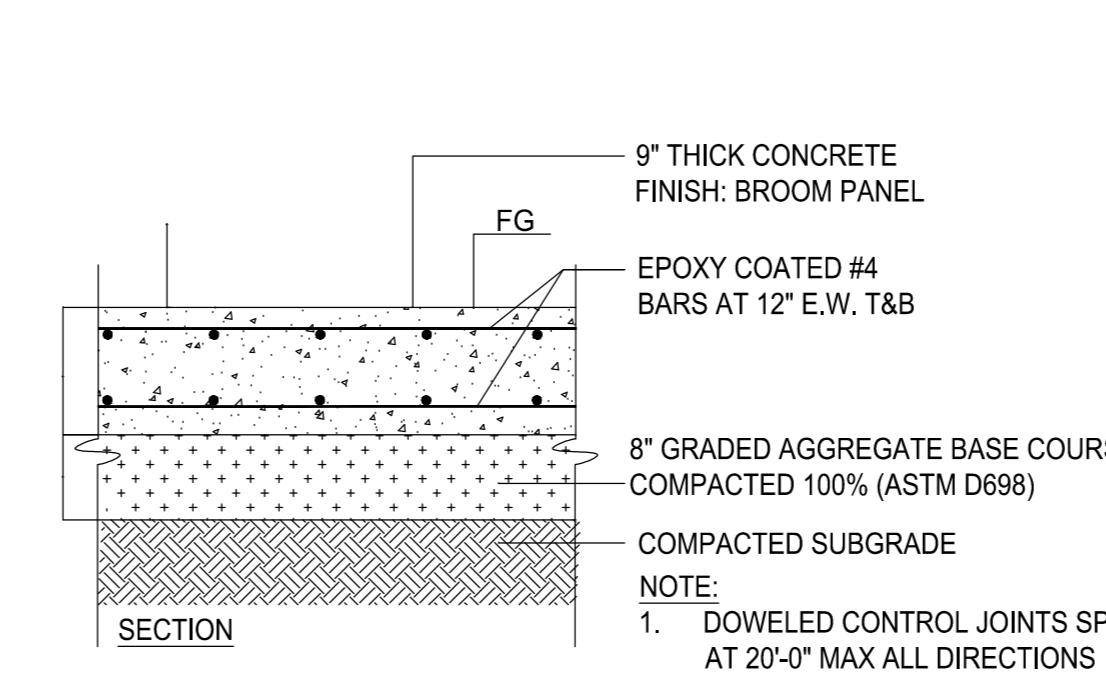

10 9" THICK HD CONC. PAVING
C-260 SCALE: N.T.S.

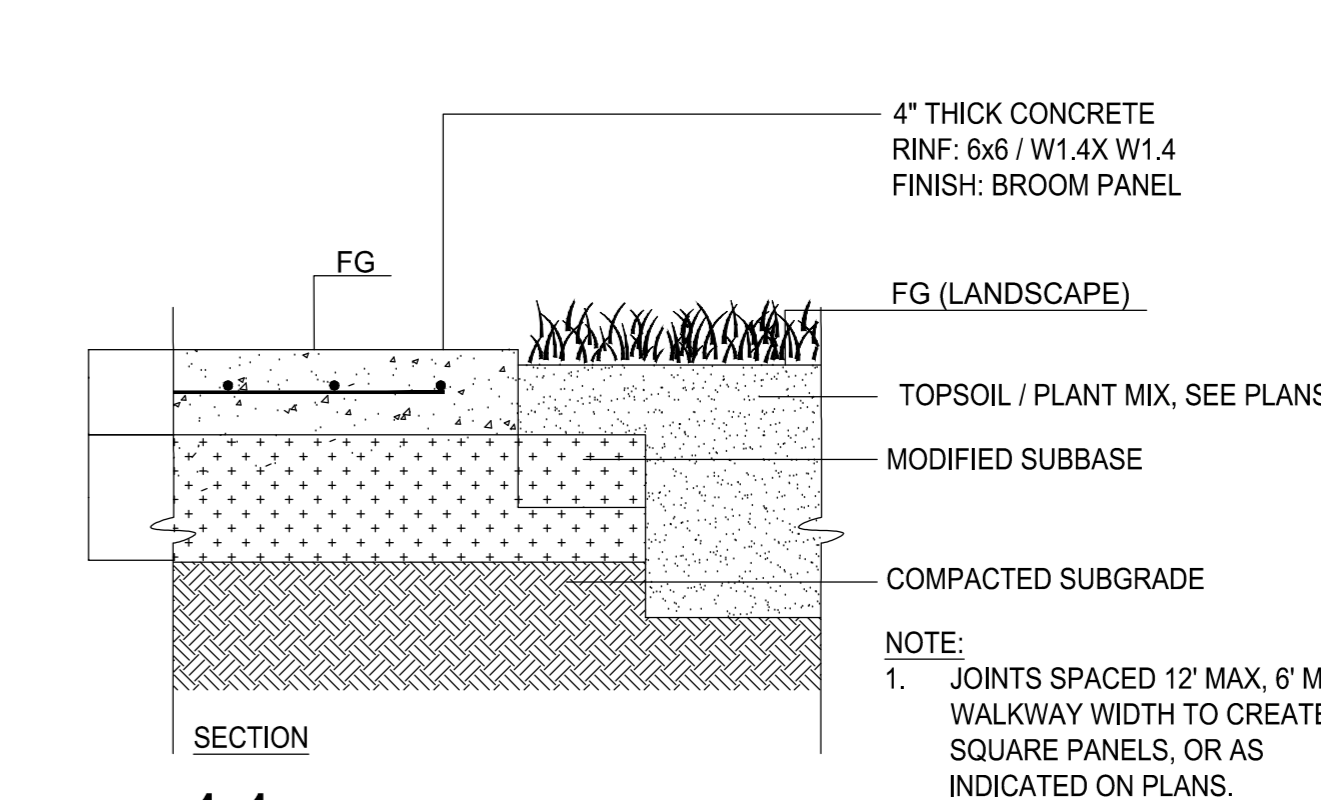

11 4" THICK CONC.
C-260 SCALE: N.T.S.

C:\Users\WRA\OneDrive - Jacobs\Desktop\Projects\Gumbo\PERMIT\UPDATE\DATE\DATE\DATE\C-260-C-264.dwg 9/15/2025 12:57 PM

REVISIONS		
NO.	DATE	DESCRIPTION
1.0	2025-06-20	TECHNICAL SITE PLAN APPLICATION
2.0	2025-09-15	TECHNICAL SITE PLAN - 2ND SUBMISSION

Drawn By: CEW
Approved By: MG
Design Team: Civil